

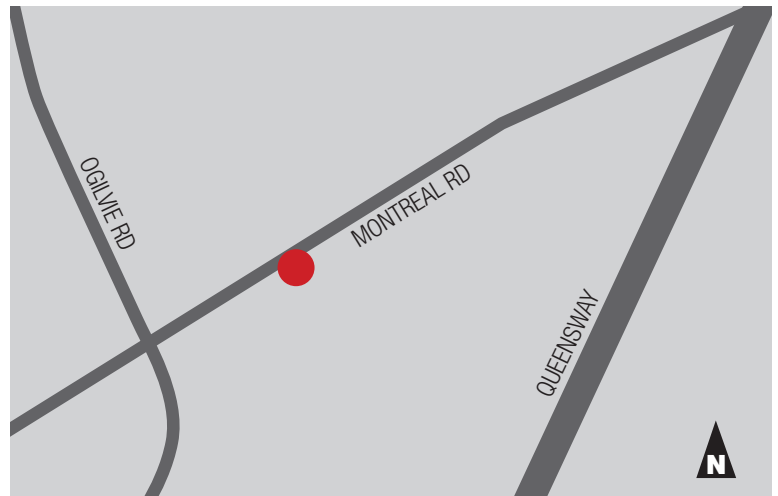

This condominium opportunity offers tenants the ability to own or lease. With signage exposure, parking and easy access, these units are ideal for independent professional practices and retail services.

RETAIL / OFFICE **635 SF - 1270 SF**

- Gross Rental Rate: \$27 PSF
- Sale Price: Inquire within
- Built out office space
- Storefront signage available
- Available Immediately
- Perfect for Professional Suites
- 3 Parking Spaces Per Unit



LOCATION

Montreal Court is located in Ottawa's east end on Montreal Road just off of Ogilvie Road and the Queensway. The site is on a highly trafficked arterial road and is easily accessed through public transportation.

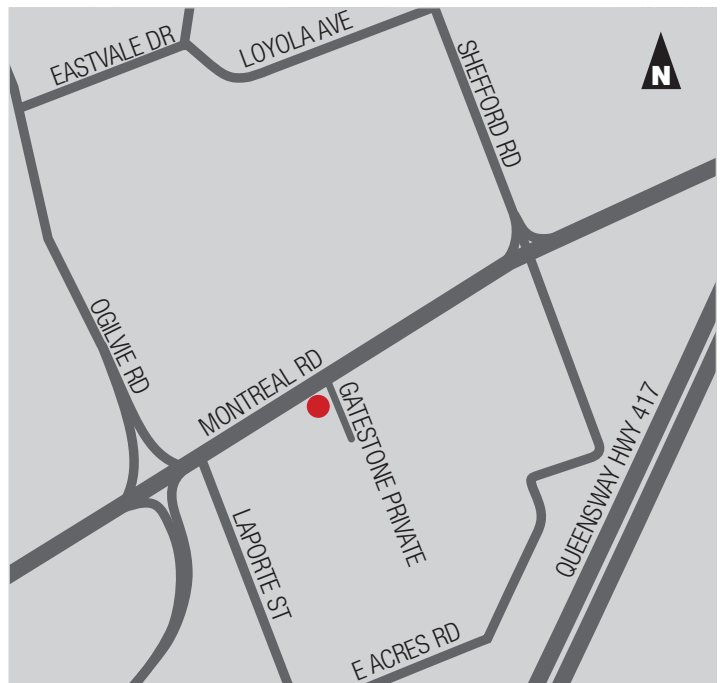
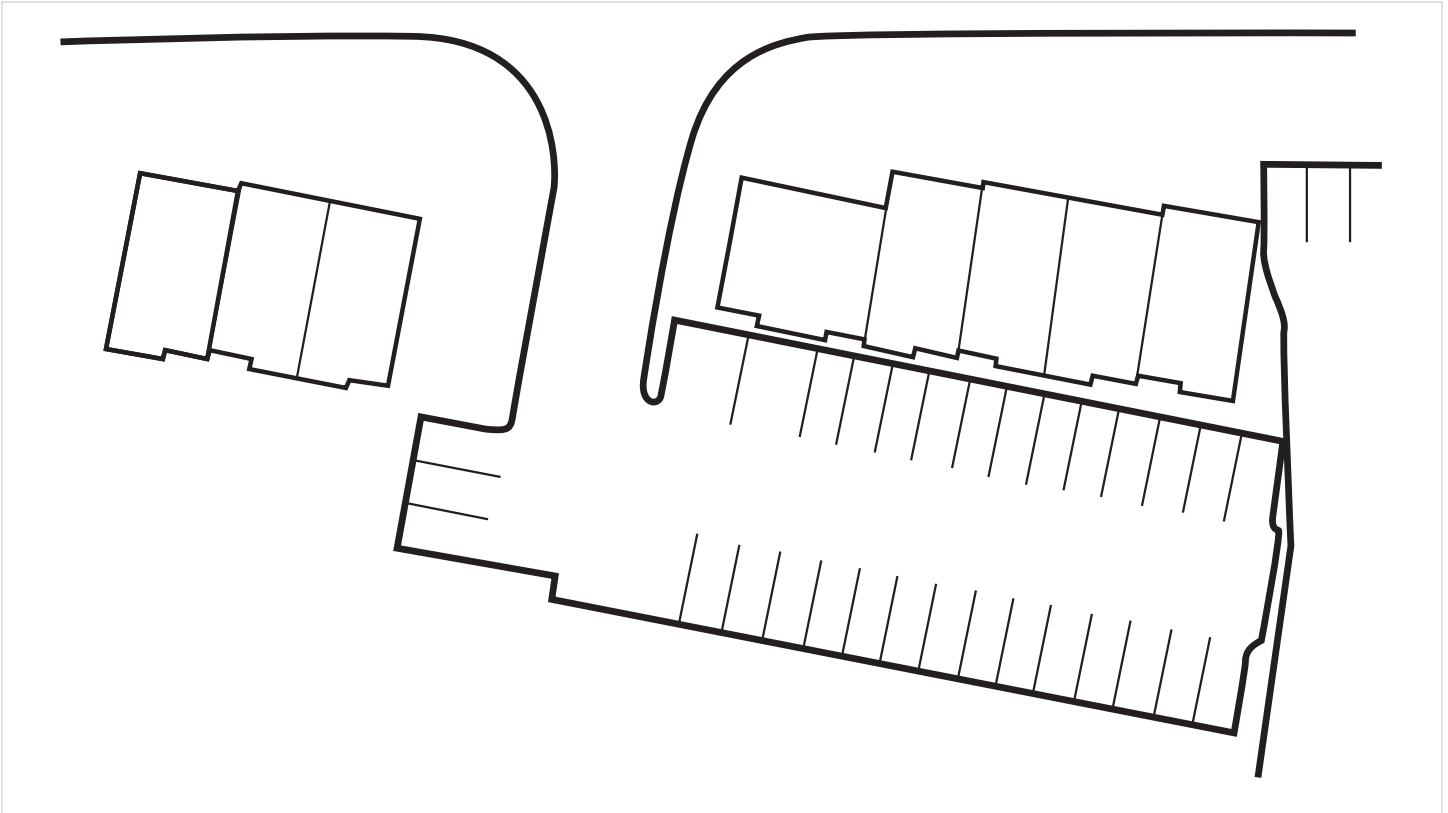



MONTREAL COURT 2120 MONTREAL ROAD OFFICE / RETAIL

