



PROPERTY DESCRIPTION

200 Terence Mathews Crescent  
Office/Commercial Space Available

200 Terence Matthews Crescent is located on the north side of Terence Matthews Cres., in the Kanata South Business Park. The Kanata South Business Park is situated at the south western edge of Kanata. It's comprised of some 180 acres of serviced land primarily zoned light industrial. Improvements typically comprise light industrial and office uses.



Civic Address	200 Terence Mathews Crescent
Location	Ottawa, Ontario
Building Size	43,015 sq.ft.
Site Area	2.25 Acres
Zoning	IP4
Surrounding Areas	Commercial, Industrial, Office

PROPERTY FEATURES

- Mix of flex industrial uses with showroom/office and warehouse
- Dock level loading doors
- 18' Ceiling height in warehouse sections
- 4.5 KM away from Highway 417 On/Off exit on Eagleson Road



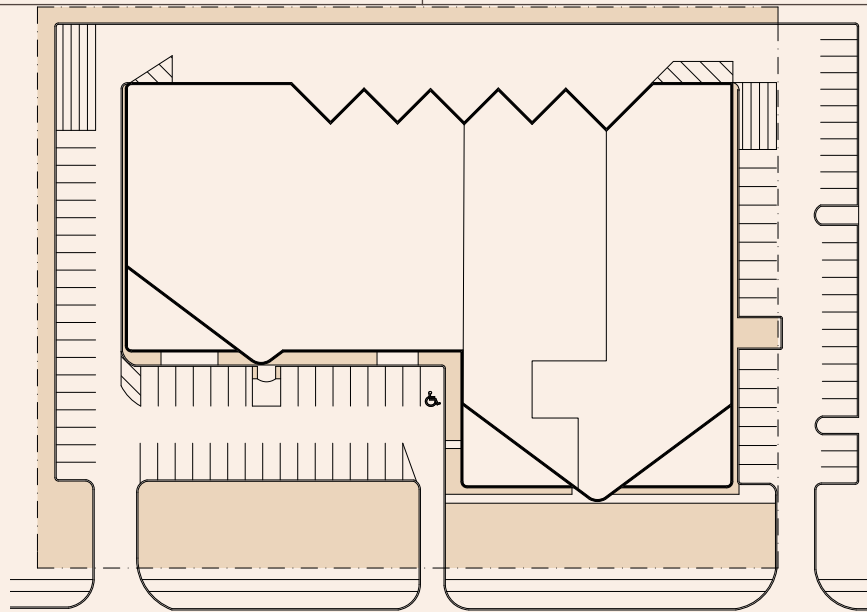

TERENCE MATTHEWS CRESCENT



**RICHCRAFT**

Ask about this space  
Call or email

[leasing@richcraft.com](mailto:leasing@richcraft.com)  
613.739.5777