



PROPERTY DESCRIPTION

2160-2170 Montreal Road  
Retail

Sinclair Plaza, built in 2010, is located in Ottawa’s east end on the south side of Montreal Road between Ogilvie Road and Highway 174. This busy corridor, just blocks from Canotek Industrial Park, is easily accessed through public transportation. The site is surrounded by dense residential and retail uses.



Civic Address	2160-2170 Montreal Road
Location	Ottawa, Ontario
Building Size	20,141 sq.ft.
Site Area	2.3 Acres
Zoning	AM10
Surrounding Areas	Residential, Retail, Commercial

PROPERTY FEATURES

- Prominent Pylon Signage exposure along Montreal Road
- Ample surface parking
- Strong mix of Medical, Retail and service users.
- Anchored by McDonald’s and Scotiabank.
- Storefront signage
- Close proximity to Highway 417 and transit

2160 Montreal Road

Retail

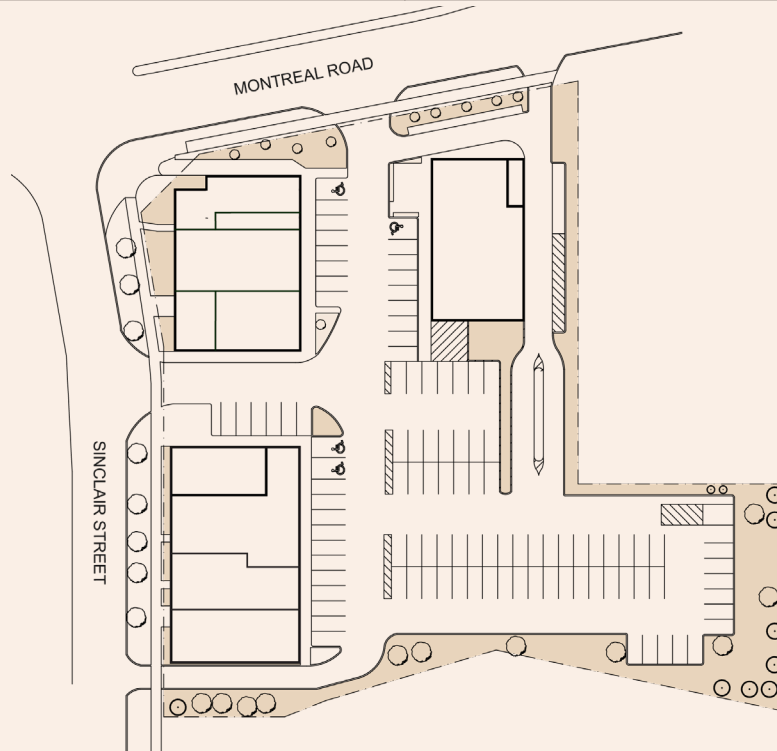

**RICHCRAFT**

Ask about this space  
Call or email

[leasing@richcraft.com](mailto:leasing@richcraft.com)  
613.739.5777